



02.05.2018

Product information plug'n'dose and plug'n'mix

Dear Sir or Madam,
Dear Trader,

thank you for the pleasant and good cooperation in 2018. Due to increasing questions about our products:

- plug'n'mix
- plug'n'dose AM

we have prepared a product information sheet for you.

On the following pages you will find an application description for both preeflow products. We have used a standard 5-axis robot with RRR kinematics to illustrate this.

In consideration of the optimum way of using our products and to avoid possible problems in advance, we support you continuously of course.

If you have any questions or suggestions about our products and applications, please do not hesitate to contact us.



Application description plug'n'mix

- The recommended installation of the plug'n'mix (Pos.2) is shown in the example of this robot (Pos.1) with RRR kinematics. **The red arrow** represents the approximate positioning point to provide enough remaining cable length.
- The included cables (Pos.4) of the eco-DUO series have a length of 1.5 m. preeflow recommends the use of the original motor cable, **without extension**. The plug'n'mix was specially developed for mounting on the robot and due to its low weight of approx. 500g the additional load on the drives is low.
 - The plug'n'mix (Pos.2) requires the following signals, e.g. from a higher-level controller (Pos.3):
 - ✓ Power supply (+24V, Ground)
 - ✓ Start (+24V)
 - ✓ Speed setting motor A (0-10VDC), speed motor B is controlled by internal processors
- optional control signals:
 - ✓ Flushing; (Flushing with mixing ratio or one component possible; see BWA page 13/14)
 - ✓ Start suckback
 - The control cable (Pos.5) between plug'n'mix (Pos.2) and the higher-level control unit (Pos.3) can be selected according to the environmental requirements in length as well as chemical and physical requirements.

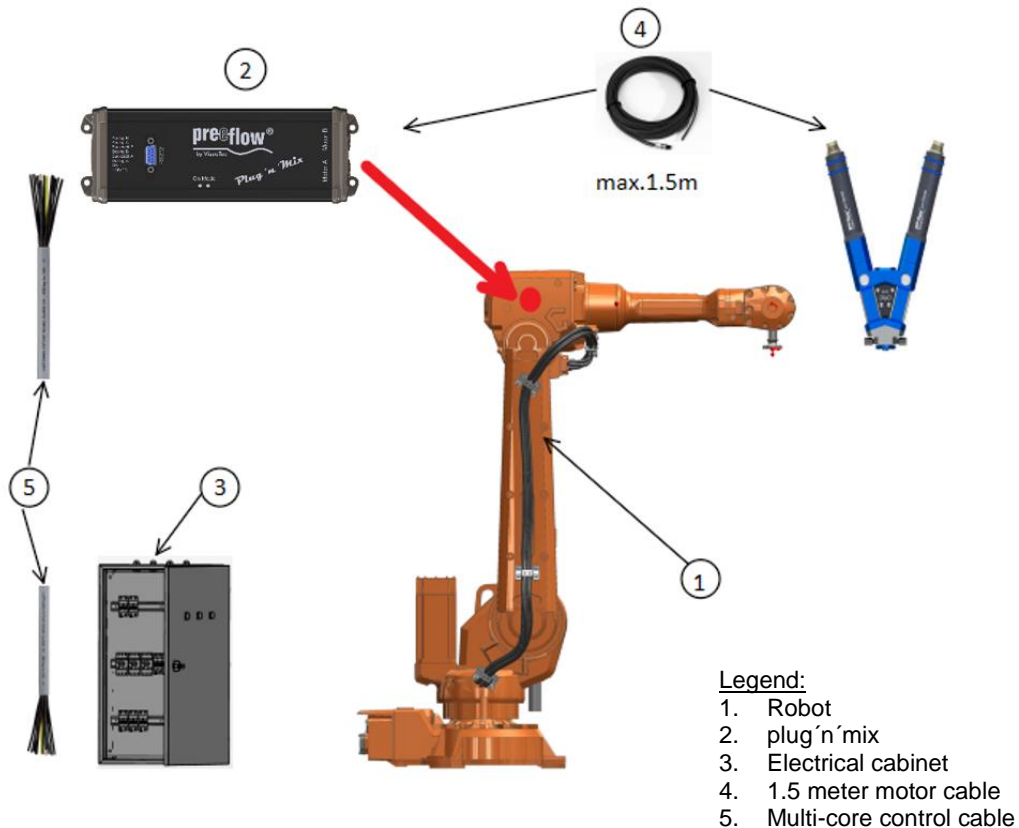

Application description plug'n'dose

- The recommended mounting of the plug'n'dose AM (Pos.2) is shown in the example of this robot (Pos.1) with RRR kinematics. **The red arrow** represents the approximate positioning point to provide enough remaining cable length.
- The cables (Pos.4) of the eco-PEN series included in delivery have a length of 1.5 meters preeflow recommends the use of the original motor cable, **without extension**. The plug'n'dose AM was specially developed for mounting on the robot and due to its low weight of approx. 260g the additional load on the drives is low.
 - The plug'n'dose AM (Pos.2) requires the following signals, e.g. from a higher-level
 - ✓ Power supply (+24V) Start (+24V)
 - ✓ GND (Ground, 0V)
 - ✓ Start signal (+24V)
 - ✓ Motor speed setting (0-10VDC)
 - optional control signals:
 - ✓ Start suckback
 - ✓ Output fault
 - The control cable (Pos.5) between plug'n'dose AM (Pos.2) and the higher-level control unit (Pos.3) included in the scope of delivery has a length of 2.5m. If necessary, this can also be replaced by a longer data cable. Please observe the pin assignment plan according to BWA p.7.

